

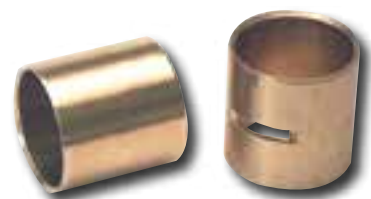

Motor Factory Wrist Pin Bushings

Premium grade bushings are machined from high phosphor bearing bronze that's up to two times as stronger than cast bushings. They have excellent hardness, strength and will help minimize wear and provide a much longer service life than plated steel backed bushings. American-made. Sold in pairs.

- 021011** Fits Sportster models from 57-03. Replaces OEM 24331-36
- 021013** Fits Big Twin models from 36-99. Replaces OEM 24334-36



Jims Piston Pin Bushing

Twin Cam 88 Bushings are sold in packs of 2. For removal and installation, use JIMS tool No.1051. To ream to correct size, use JIMS No.1726-3 wrist pin reamer. Bushing O.D. is 1.017" +-.0005, I.D. is .927" (repl. OEM# 24316-99). Use on all Twin Cam 88 models.

- 696587** Piston pin bushing



Wrist Pin Bushing by Kibblewhite

Made from solid U.S. Mill certified SAE 660 bearing bronze bar stock. This material is resistant to impact, wear, and corrosion, and has superb anti-friction properties. It also has excellent machinability, meaning a high quality surface finish can be achieved. This combination of mechanical properties creates a tough durable bushing that will meet or exceed the fitment and service life of all other replacement style bushings available. Wrist pin bushings come in standard size or 0.002" oversized. Designed for Panhead 48-65, Shovelhead 74" 66-77, Shovelhead 80" 78-83, and Evolution 84-99.

- Sold in pairs.**
- 622236** Standard 0.897" in.
 - 622237** Oversize 0.899" in.



Engine Roller Bearings

American-made rollers. Sold in resealable bags of 100.

Short Rod Rollers

Fits 1952 K-models and OHV Big Twins 51-72 (36 used)

CCI #	Jims	Size	OEM #
		.1875 x .329 Std.	9101A
49002	696573	+.0004	9103A
	696576	+.001	9106A

Fits Sportster and KH models 54-E86 and Big Twins from 73-86 (34 used)

CCI #	Jims	Size	OEM #
		.1875 x .294 Std.	9441A
49026	696592	+.0002	9442A
	696593	+.0004	9443A
	696594	+.0006	9444A
49029	696595	+.0008	9445A
		+.001	9446A
49031	696597	+.002	9418
49032		+.003	n/a
49033	696599	-.0002	9450A

Long Rod Rollers

Fits Big Twins from 73-86 (17 used)

CCI #	Jims	Size	OEM #
	696580	+.0002	9180
	696581	+.0004	9181
49019	696582	+.0006	9182
	696583	+.0008	9183
	696584	+.001	9184
	696585	+.002	n/a

Crankcase Rollers for Big Twins

Fits the left case of OHV Big Twins 30-57 (24 used), and the right case 58-86 (28 used). Also fit all early wheels.

CCI #	Jims	Size	OEM #
	696607	+.0002	9221A
	696608	+.0004	9222A
	696609	+.0006	9223A
49052	696610	+.0008	9224A
49053	696611	+.001	9225A
	696612	+.002	n/a

Right Side Crankcase Rollers for Sportster and Big Twin Models

Fits 57-76 Sportster models and 55-57 OHV Big Twins (13 used)

CCI #	Jims	Size	OEM #
49043	696601	+.0002	9422
49044	696602	+.0004	9423
49045	696603	+.0006	9424
49046	696604	+.0008	9425
49047	696605	+.001	9426

- ★ APPAREL
- ★ SEATS & TOURING
- ★ FOOT CONTROLS
- ★ HAND CONTROLS
- ★ LIGHTING
- ★ ELECTRICAL
- ★ EXHAUST
- ★ INTAKE
- ★ ENGINE
- ★ GASKETS
- ★ TRANNY & CLUTCH
- ★ DRIVELINE
- ★ WHEELS, TIRES & BRAKES
- ★ FRAMES
- ★ FORKS & SHOCKS
- ★ SHEETMETAL
- ★ INSTRUMENTS & GAUGES
- ★ LUBRICANTS & CHEMICALS
- ★ TOOLS & EQUIPMENT
- ★ LAST MINUTE