

## Generator Parts

Listed below in CC part number order

- 15927** 12-volt field coils. Fit 65-81 Sportster and Big Twin models (repl. OEM 30201-65T) sold in pairs
- 19324** 12-volt armature. Fits 65-81 Sportster and Big Twin models (repl. OEM 30851-65TA)
- 19772** 14-tooth drive gear. Fits 63-E84 Sportster models (repl. OEM 31073-63TA)
- 19782** 13-tooth drive gear. Fits 58-69 Big Twin models (repl. OEM 31070-58T)
- 25020** Bearing, drive gear. Fits 58-81 Big Twin and Sportster models (repl. OEM 9007)
- 25306** Oil seal, end cover. Fits 61-73 Big Twin and Sportster models (repl. OEM 12002) pack of 5
- 26160** Oil deflector (repl. OEM 31035-58) sold each
- 26161** Washer, oil deflector (repl. OEM 31067-63) pack of 10
- 54061** Oil seal, drive gear. Fits 46-81 Sportster and Big Twin models (repl. OEM 30145-46A) pack of 10
- 660511** Gasket. Fits 58-E84 Sportster and Big Twin models (repl. OEM 30143-58) pack of 10



### Accel Generator Field Coils

Features, high-strength, warp-free laminates; heat-resistant, heavy-gauge, copper core wiring; woven cloth laminate insulation (not paper); precision-soldered field and ground terminals and each pair is matched for exact amperage values. Sold in pairs.

- 25503** Fits all 12-volt #65, #64 and #66A model generators on Harley models from 65-81 (repl. OEM 30201-65)



### Battery Eliminator Kit by Accel

Boost spark voltage at cranking and eliminate flickering lights at low speed with ACCEL Motorcycle battery eliminator. Includes shock-resistant mounting clamps and attachment hardware. Made in the U.S.A.

- 668371** Battery eliminator

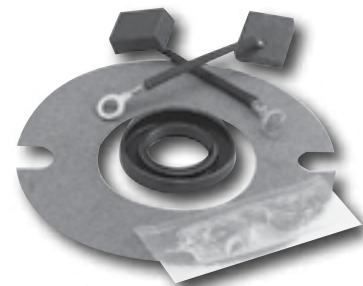

### Accel Generator Repair Kit

Top-quality American-made generator repair kit for 12-volt, 2-brush generators. Fits FL models from 65-69 and Sportster models from 65-81. Kit includes a pair of brushes, gasket, seal and packet of grease.

- 25515** Repair kit



### Generator Brush Set by Standard

Replacement brush set for all two brush generators from 58-64.

- 668343** Brush set



### Accel Generator Brush Sets

Premium-quality, American-made generator brush sets for two- and three-brush generators. Sets are pressure-molded and precision-ground for long life from carbon-graphite. Retaining springs are made from piano-grade tin music wire, with brass terminals fitted to copper alloy braided cable leads.

- 12341** FL, FLH Twins, XL, XLH, XLCH Twins 58-64, Generator #58 & 61/6V, OEM 30426-58

- ★ APPAREL
- ★ SEATS & TOURING
- ★ FOOT CONTROLS
- ★ HAND CONTROLS
- ★ LIGHTING
- ★ ELECTRICAL
- ★ EXHAUST
- ★ INTAKE
- ★ ENGINE
- ★ GASKETS
- ★ TRANNY & CLUTCH
- ★ DRIVELINE
- ★ WHEELS, TIRES & BRAKES
- ★ FRAMES
- ★ FORKS & SHOCKS
- ★ SHEETMETAL
- ★ INSTRUMENTS & GAUGES
- ★ LUBRICANTS & CHEMICALS
- ★ TOOLS & EQUIPMENT
- ★ LAST MINUTE