

Star Hub Rebuild Kit

Kit includes necessary bearings, retainers, seals, gaskets, thrust washers, spacers and bearing sleeve to rebuild the stock style "Star" hub. Fits Big Twins front or rear wheels 36-66.

140353

140350

140352

Hub Rebuild Kits

Hub rebuild kits for most Big Twin and Sportster models 36-99 with steel or aluminum hubs. Available with or without bearings, these kits include seals, bearing spacers, center spacers (between bearings) snap rings, washers and gaskets necessary to rebuild the specific hubs listed.

Note: Kits do not contain outer axle spacers.

With Bearings	Without Bearings
Fits dual flange hubs front and rear on FL models 73-83, front FXWG 80-84 and rear FX models 73-82. Contains 4.434" (yellow) center spacer	
140350	140349
Fits "Mid star" hubs front and rear on FL models from 67-72 and rear on FX models from 71-72	
	140356
Fits Sportster rear hubs from 55-78	
140352	140355

Star Hub Cover Kit

Includes the chrome outer cover, inner cover with grease fitting, gasket and corks, screws and lockwashers.

19578 Fits Star Hubs from 36-66

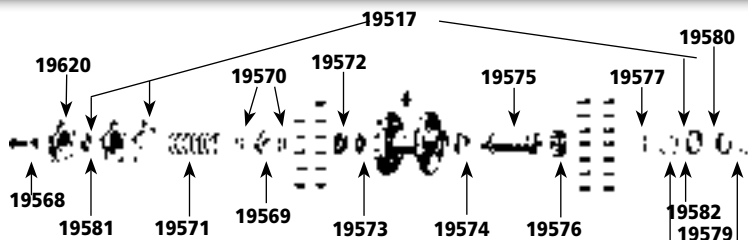
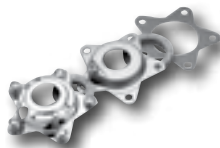

Original Equipment-Style Star Hub Replacement Parts

- 19569** Thrust bearing sleeve (repl. OEM 43556-35)
- 19570** Thick thrust washers (repl. OEM 43563-35) 5 pair
- 19571** Adjusting shims (.002") repl. OEM 43560-35 (pack of 50)
- 19572** Retainer and rollers (repl. OEMs 24721-30, 9220A)
- 19573** Inner thrust washer (repl. OEM 43552-39) pack of 10
- 19574** Bearing collar (repl. OEM 43561-39)
- 19575** Roller bearing sleeve (repl. OEM 43550-35)
- 19576** Brake side retainer and rollers (repl. OEMs 43578-35, 9220A)
- 19577** Brake side thrust washers (repl. OEM 43558-39) pack of 10
- 19579** Thrust washer lockring (repl. OEM 43554-35) 5 pair
- 19580** Brake side cork washer retainers (repl. OEM 43564-35) pack of 25
- 19581** Small cork washer (repl. OEM 43570-35) pack of 10
- 19517** Gasket and cork washer kit (repl. OEMs 43570-35, 43571-35, 43576-31)
- 19582** Large brake side cork washers (repl. OEM 43571-35) pack of 10
- 19620** Outer cover without hole for zerk fitting (repl. OEM 43566-35TA)
- 19568** Hub cover screw/lockwasher kit (pack of 5)

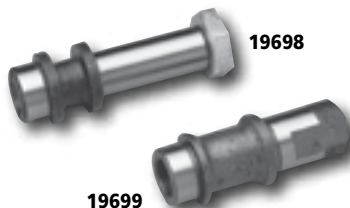

Axle Sleeves for Star Hubs

- 19698** Front axle sleeve (brake side) for Big Twins from 49-66 (repl. OEM 43882-48)
- 19699** Left rear axle sleeve for Big Twins from 36-57 (repl. OEM 41600-36)

Hub and Brake Drum Bearing

Fits all Big Twin hubs from 67-72. Made in the U.S.A. to exacting tolerances that duplicate Original Equipment specifications.

- 26133** Replaces OEM 43577-67 (sold each)

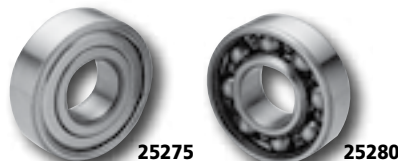

Wheel Bearings for Early Sportster Models

- 25275** Shielded bearing for the rear of models from 63-77 that use one on brake side and one on sprocket side outer (repl. OEM 9009)
- 25280** Unshielded bearing for the rear of models from 63-77 that use one on the sprocket side inner (repl. OEM 9008)



All Balls Wheel Bearing & Seal Kit

The Kit contains two bearings and two seals to fit H-D models 73-99.

- 653877** Wheel bearing & seal kit

